

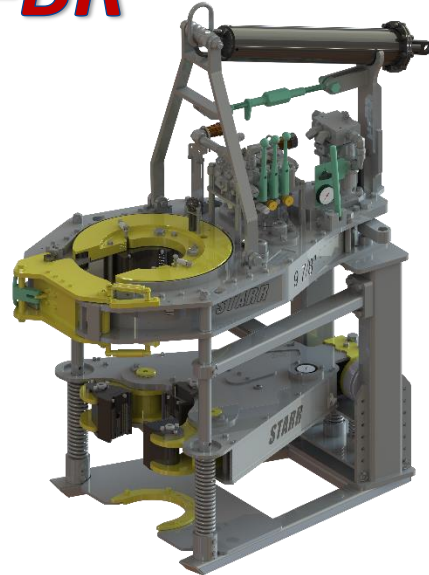

**STARR**  
POWER TONGS

# 9-7/8" 60 SPECIFICATIONS

## 9-7/8" 60-BR

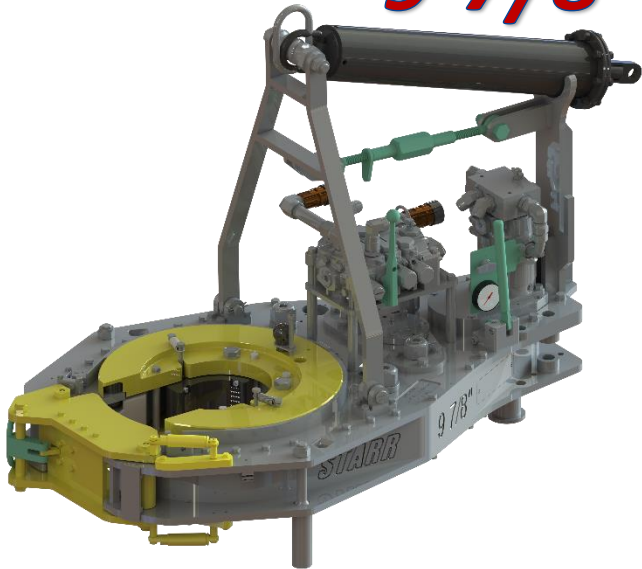

TORQUE - Rineer 21IN <sup>3</sup> 60K Tong					RPM - Rineer 21IN <sup>3</sup> 60K Tong				
Press.	Speed 1	Speed 2	Speed 3	Speed 4	GPM	Speed 1	Speed 2	Speed 3	Speed 4
PSI	ft-lb.	ft-lb.	ft-lb.	ft-lb.					
2000	46,415	8,186	23,208	4,093	10	0.9	5	1.8	10.1
2250	52,217	9,210	26,109	4,605	20	1.8	10.1	3.6	20.2
2500	58,019	10,233	29,009	5,117	40	3.6	20.2	7.1	40.4
2750	63,821	11,256	31,910	5,628	60	5.3	30.3	10.7	60.6
3000	69,623	12,280	34,811	6,140					

**NOTE – 2 Options Available**  
**9-7/8" 60** – (1 Handle – 2 Capped Valves)  
**9-7/8" 60-BR** (Ready to Receive 10-3/4 Backup)

	Motor Shift	Tong Transmission Shift
<b>Speed 1</b>	Low Gear	Low Gear
<b>Speed 2</b>	Low Gear	High Gear
<b>Speed 3</b>	High Gear	Low Gear
<b>Speed 4</b>	High Gear	High Gear

	9 7/8" Tong	w/ Backup
Capacity	4 1/2"-9 7/8"	3 1/2"-10 3/4"
Width	37" (94 cm)	40.8" (103.6 cm)
Length	61.3" (155.7 cm)	62.5" (158.8 cm)
Height	47.5" (120.6 cm)	78.9" (200.4 cm)
Weight	2,150lb. (977kg)	3,300lb. (1'500kg)
Rated Pressure	2500 psi	
Rated Torque	60,000 ft-lbs.	
Handle Length	36" (91.4 cm)	

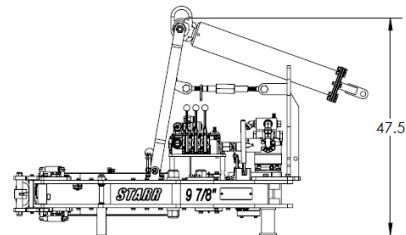
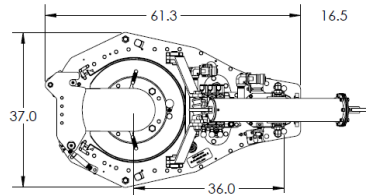
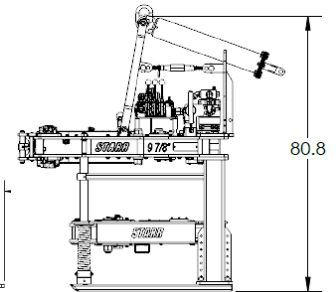
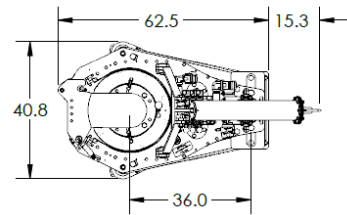

**TONG JAWS AVAILABLE: 4 1/2" – 9 7/8"**  
**BACKUP JAWS AVAILABLE: 3 1/2" – 10 3/4"**

(Other sizes available upon request)

Disclaimer: Technical Values are +/- 5% of Listed Values